



Nothing but **HEAVY DUTY.**



M18 FOPH-LTA

Original instructions

The illustration shows the application head M18 FOPH-LTA connected to the Milwaukee powerbase M18FOPH-0. This application head may only be operated in connection with the powerbase shown here. Depending on the equipment package you have purchased various application heads. Other application heads and powerbases can be purchased separately.



For the following instructions of the powerbase in connection with this application head please refer to the separate instructions for the power base

- connecting the application head with the powerbase
- switching on-off
- speed selection
- change battery



1

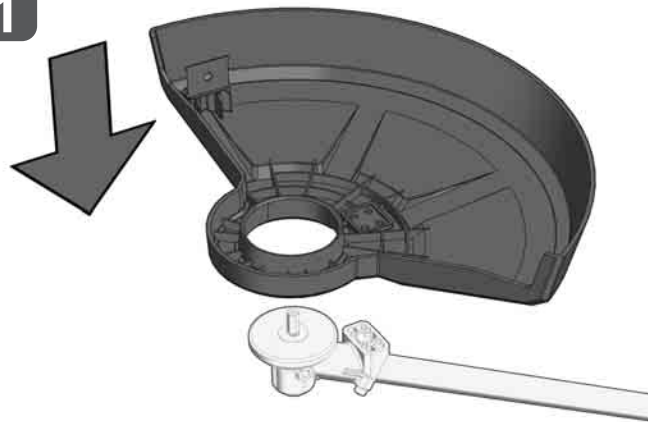

2

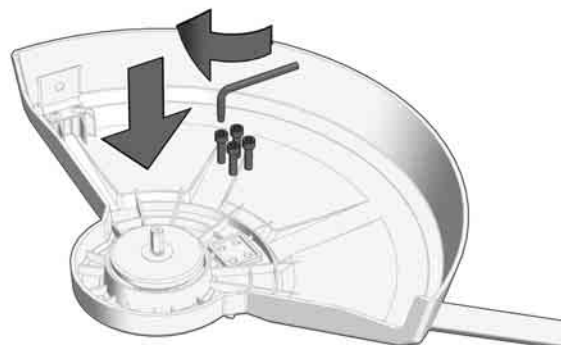

1

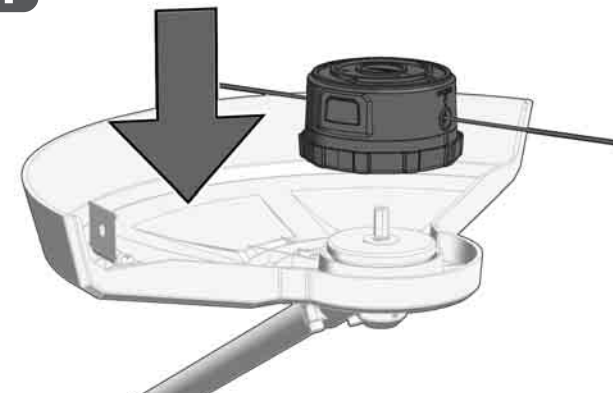

2

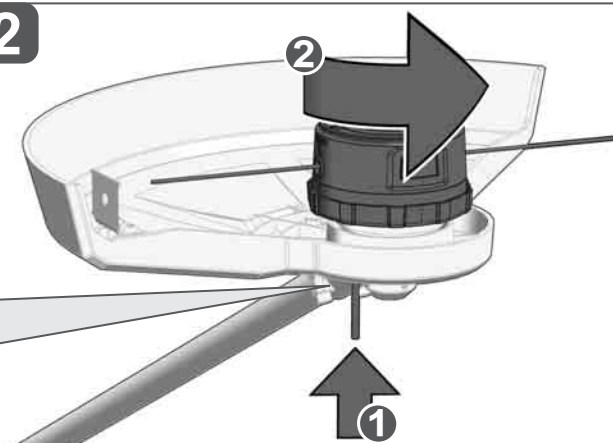
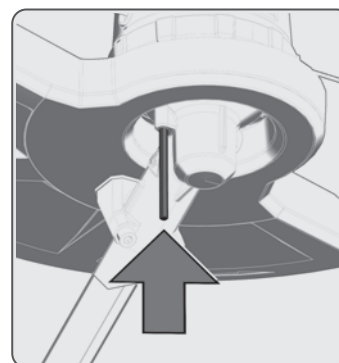

3

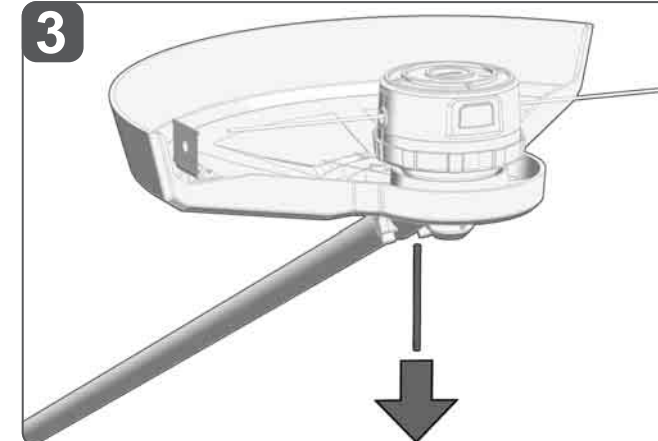

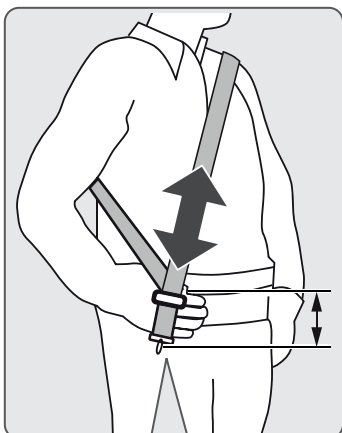
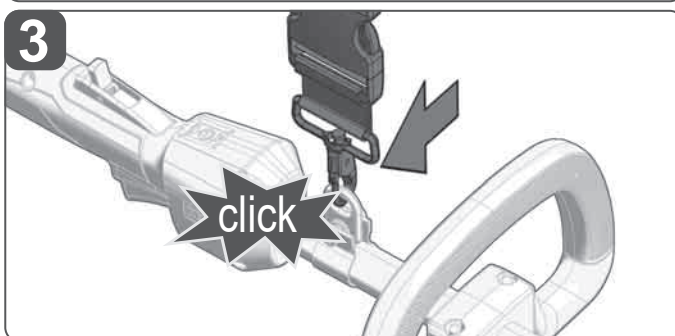
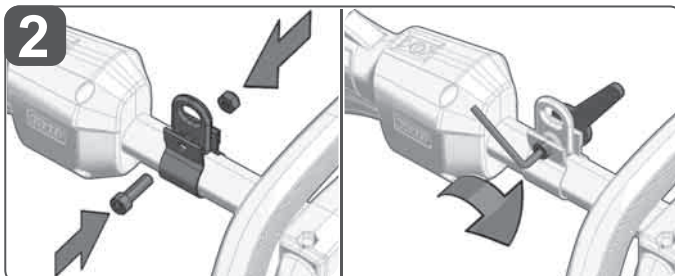
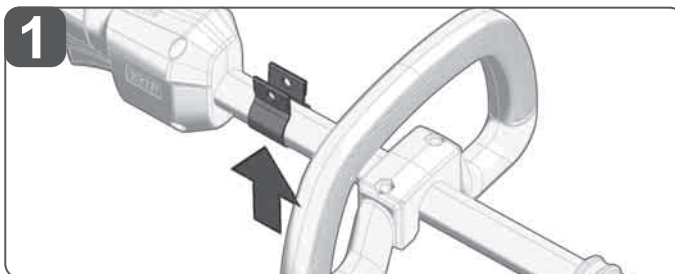
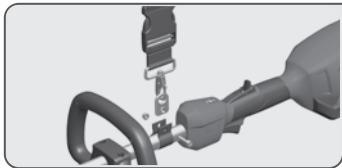

Adjust the strap. The carabiner should be a hand's width below your hip.

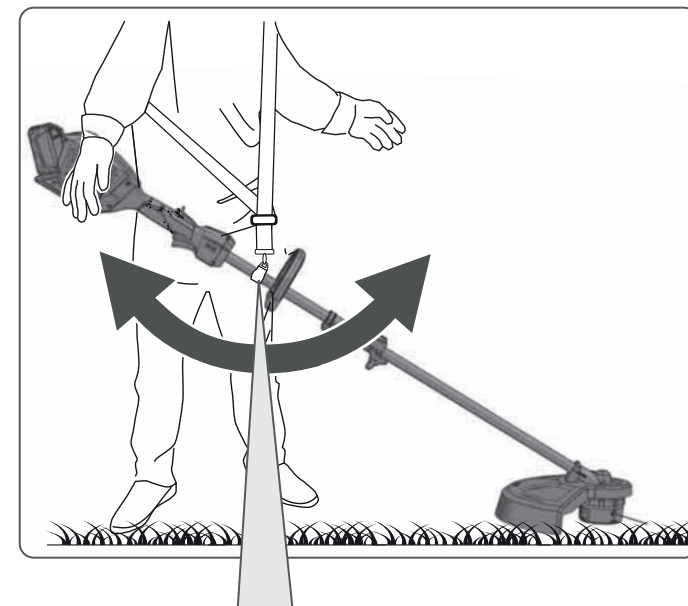
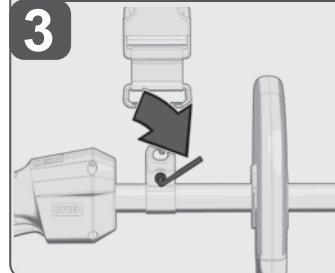
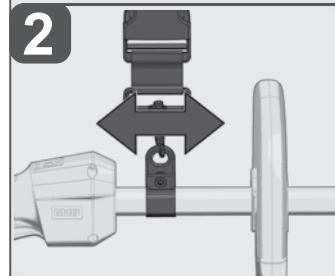
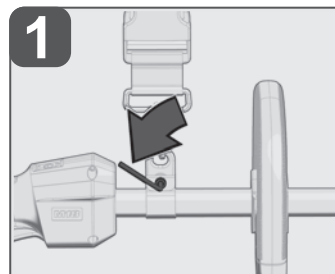

Level the appliance. The blade should touch lightly the ground.

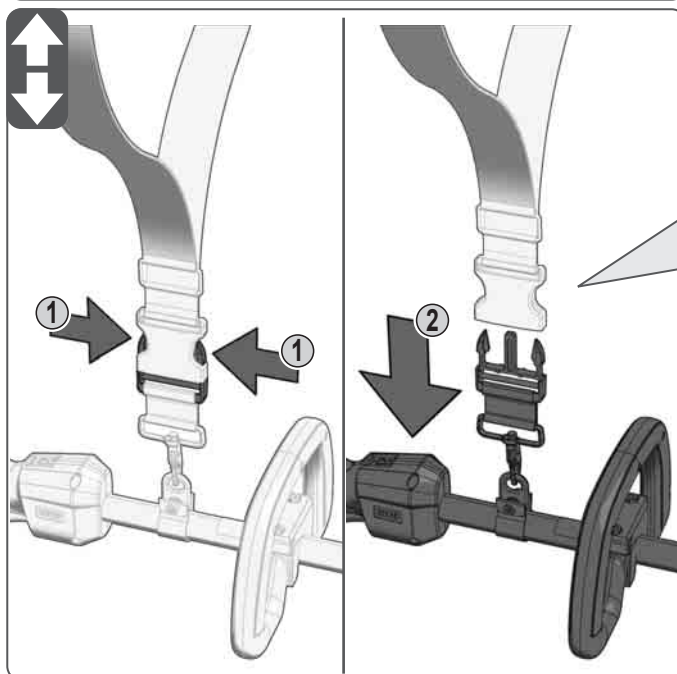
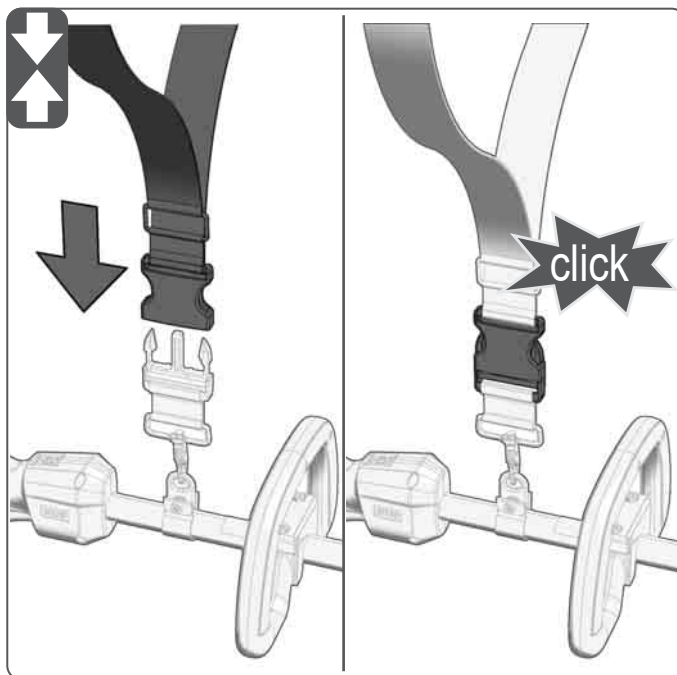

Quick release:
In case of imminent danger, the device must be jettisoned quickly. To do this, open the lock and set down the device. Practise quick release. Do not throw the device during practice!



Insulated gripping surface

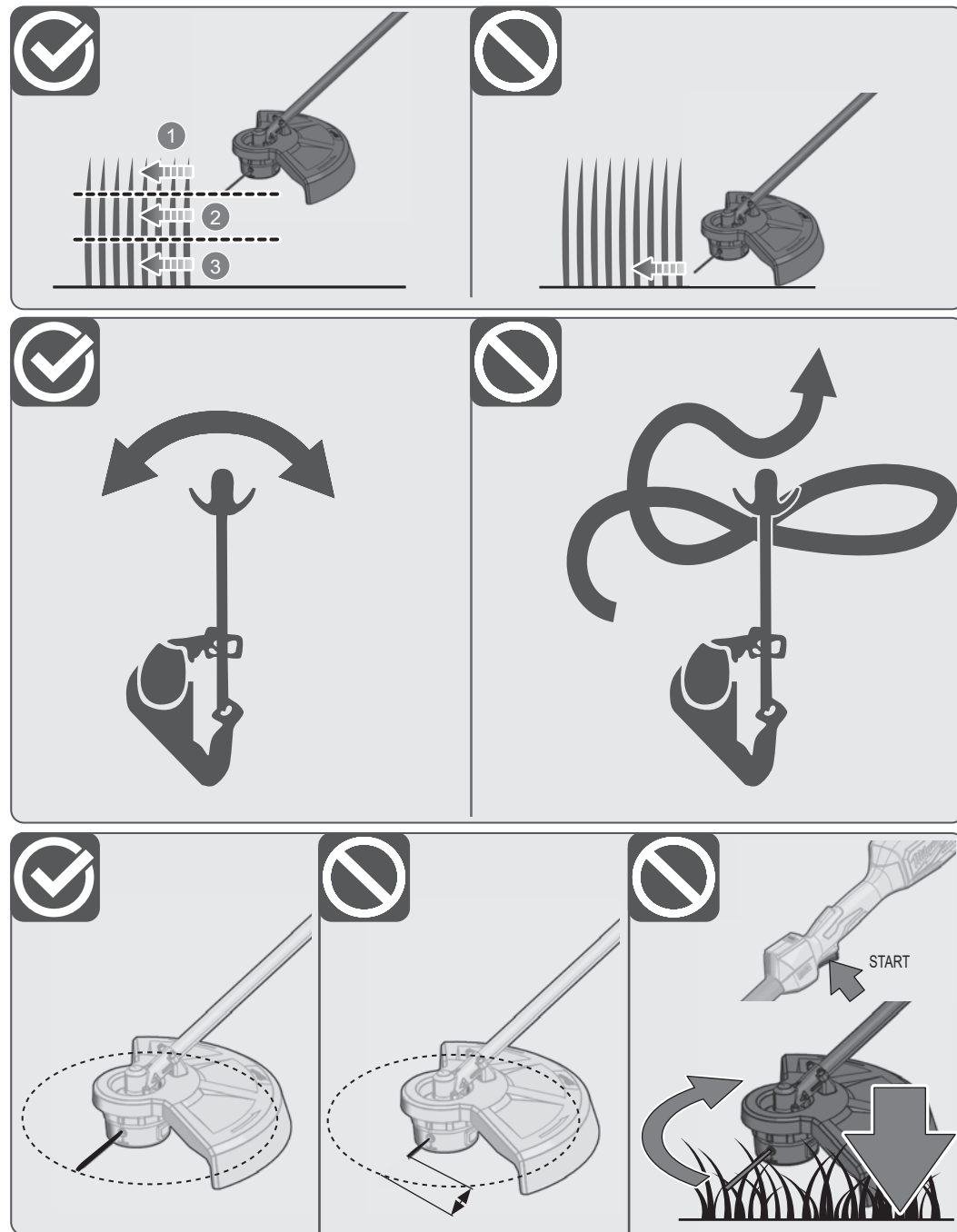
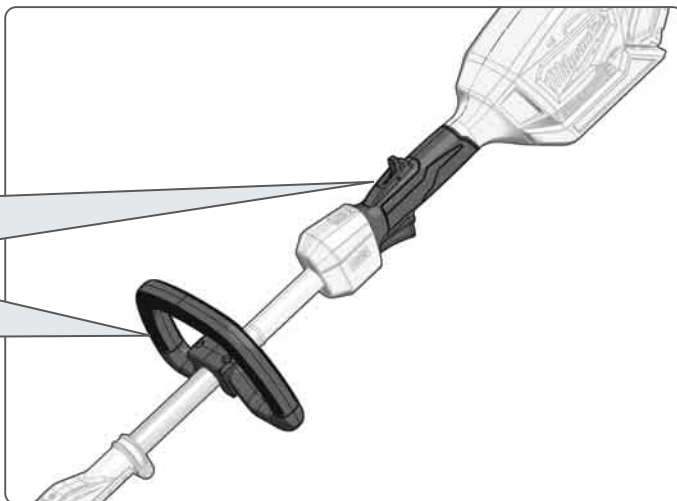

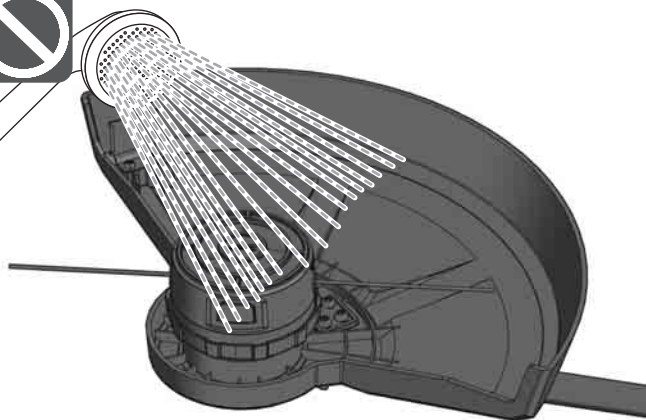
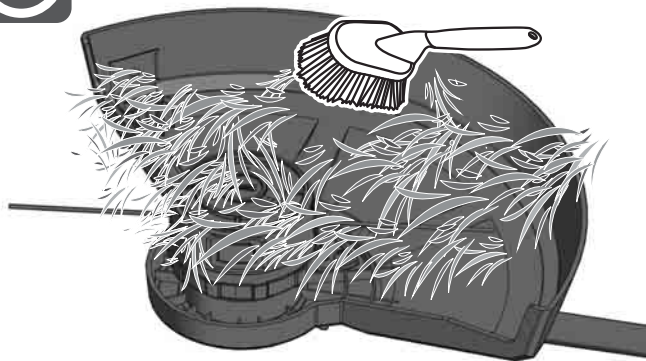

1

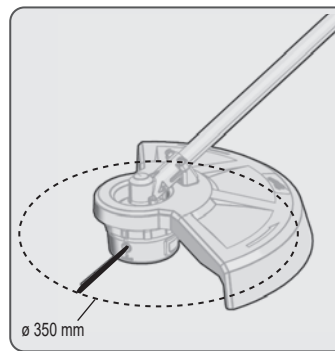
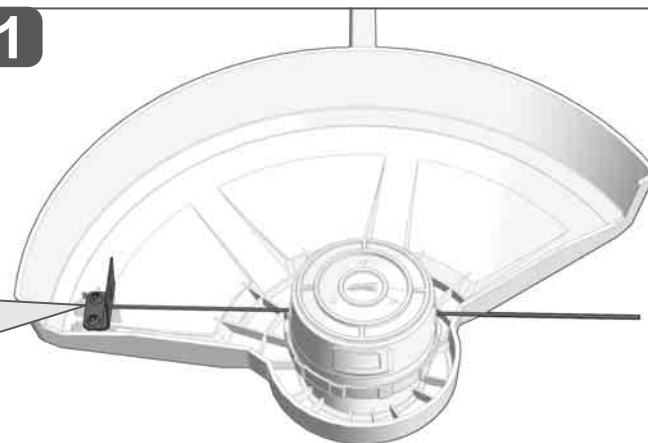

2

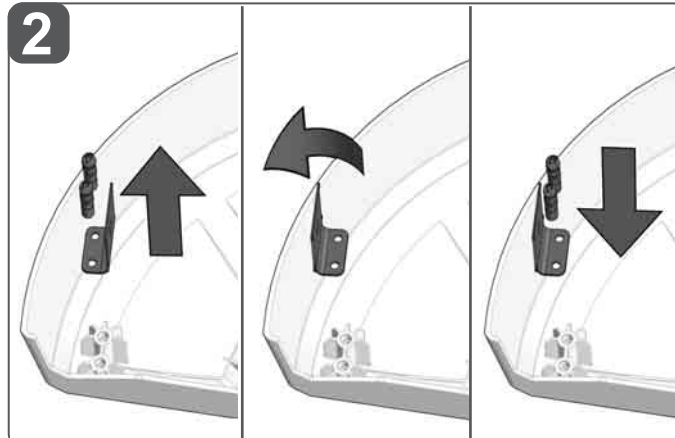

3

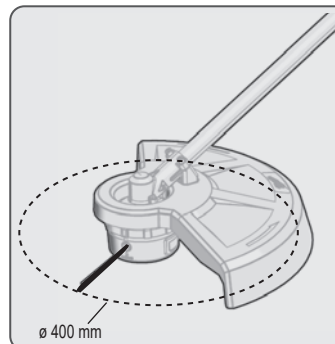
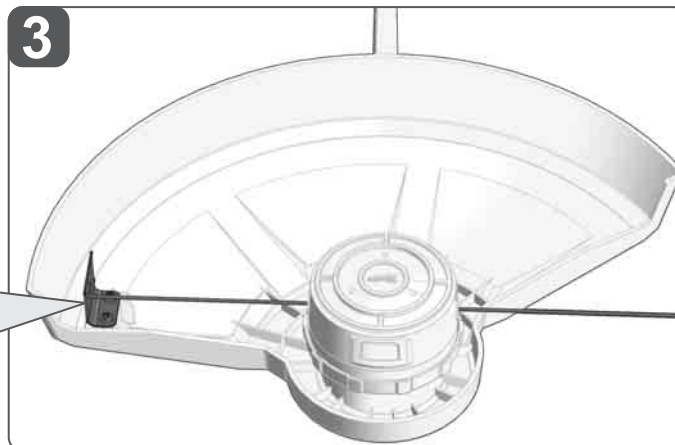



1

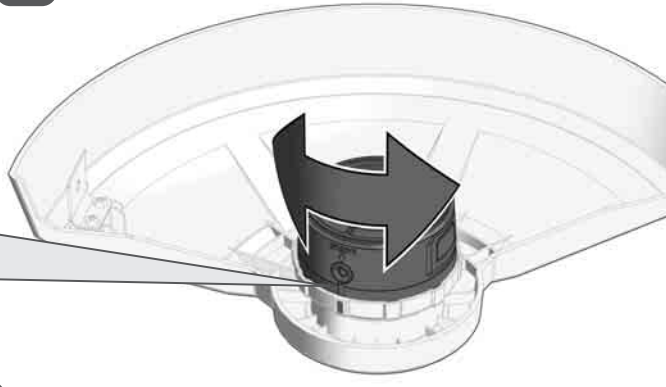

2

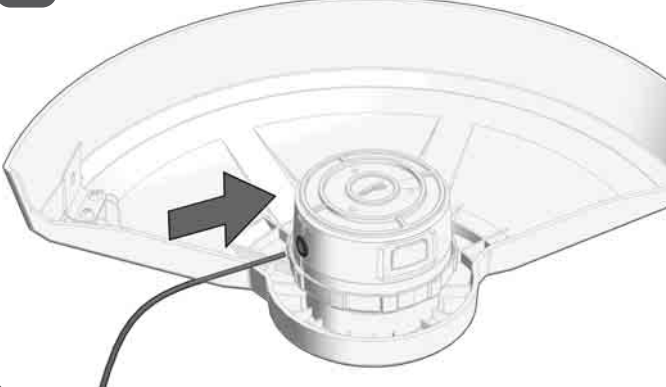

3

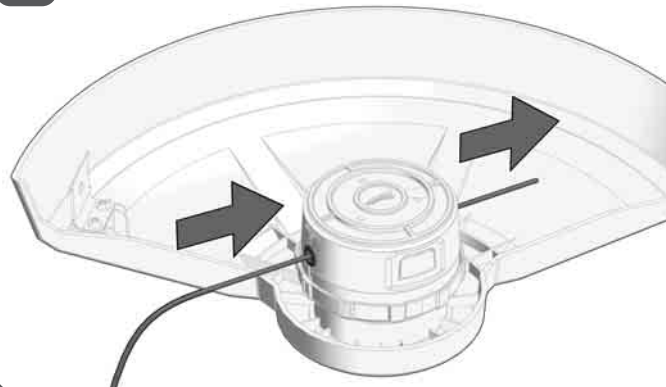

4

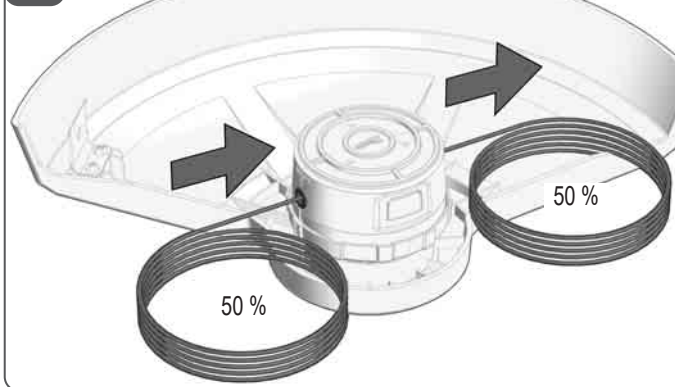

5

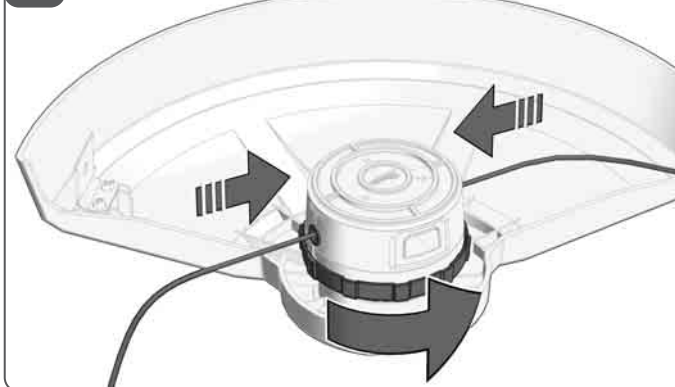

6

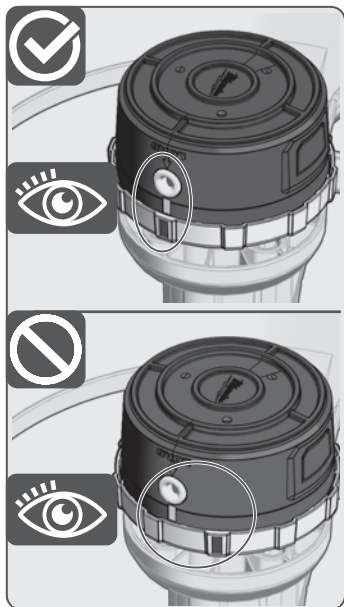
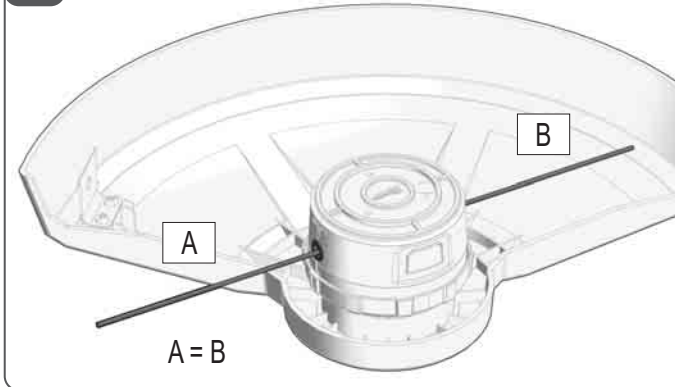



1

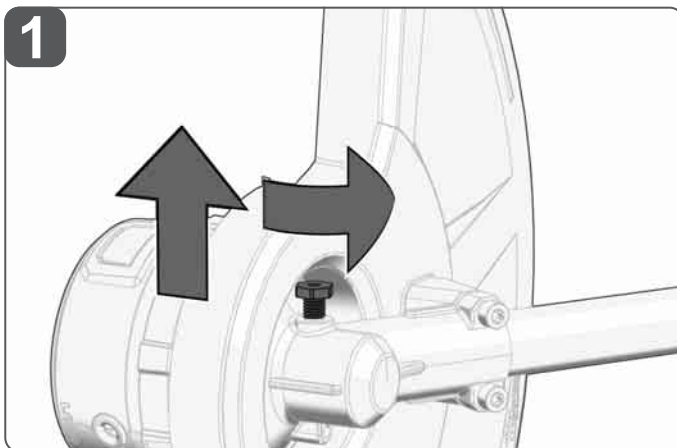

2

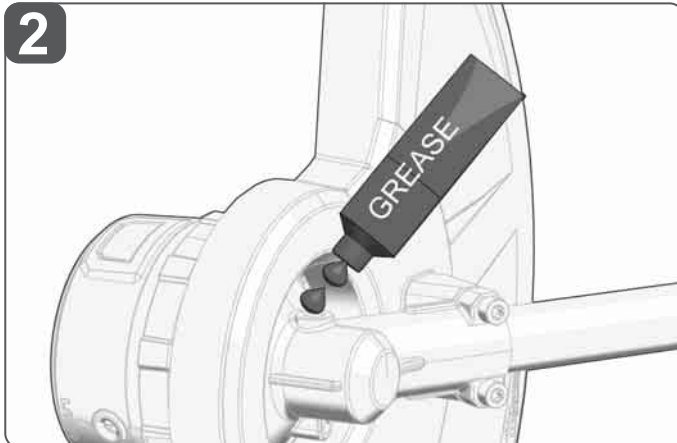

3

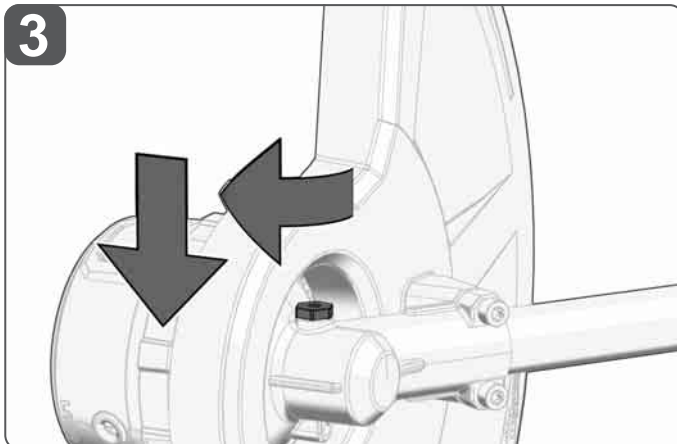



Accessories / Spare parts

4932 4801 80

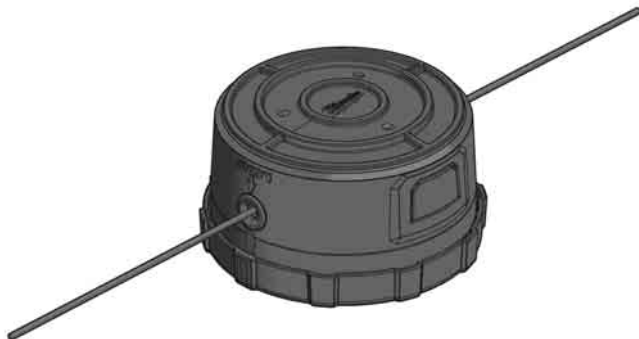

491 627 12
2,0 mm

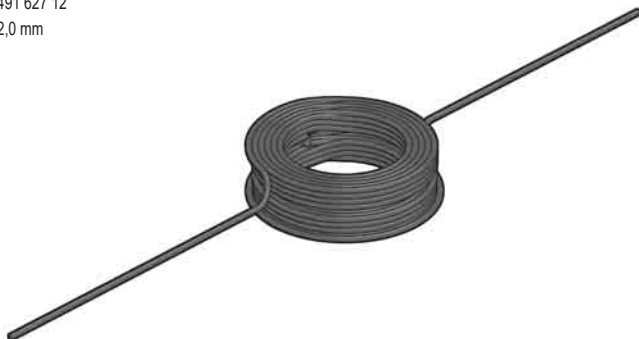

491 627 13
2,4 mm

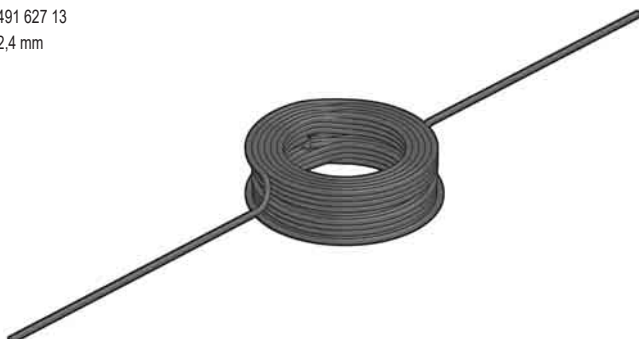

TECHNICAL DATA	M18 FOPH-LTA
Type	Cordless Lawn Trimmer
Production code	4916 06 01 XXXXXX MJJJJ
Voltage battery	18 V ---
No-load speed, low speed	0-4900 min ⁻¹
No-load speed, high speed	0-6200 min ⁻¹
Cutting line ø max.	7,6 m x 2 mm / 6,1 m x 2,4 mm
Cutting capacity max.	400 mm
Weight according EPTA-Procedure 01/2014	1,7 kg
Recommended ambient operating temperature	-18...+50 °C
Recommended battery types	M18B...; M18HB...
Recommended charger	M12-18...; M1418C6
Noise information: Measured values determined according to EN 50636 / EN ISO 4871.	
Typically, the A-weighted noise levels of the tool are:	
Sound pressure level / Uncertainty K	79 dB(A) / 3 dB(A)
Sound power level / Uncertainty K	93 dB(A) / 3 dB(A)
Always wear ear protectors!	
Vibration information: Total vibration values (vector sum in the three axes) determined according to EN 50636.	
Vibration emission value a _h / Uncertainty K	7,5 m/s ² / 1,5 m/s ²
For technical data and approvals of application heads for use on various powerbases please refer to the operating instructions of the used application head.	

 **WARNING!**

The vibration and noise emission level given in this information sheet has been measured in accordance with a standardized test given in EN 60335-1 / EN 50636-2-91 and may be used to compare one tool with another. It may be used for a preliminary assessment of exposure.

The declared vibration and noise emission level represents the main applications of the tool. However if the tool is used for different applications, with different accessories or poorly maintained, the vibration and noise emission may differ. This may significantly increase the exposure level over the total working period.

An estimation of the level of exposure to vibration and noise should also take into account the times when the tool is switched off or when it is running but not actually doing the job. This may significantly reduce the exposure level over the total working period.

Identify additional safety measures to protect the operator from the effects of vibration and/or noise such as: maintain the tool and the accessories, keep the hands warm, organization of work patterns.

 **WARNING** Read these instructions carefully, be familiar with the controls and the proper use of the machine. Save all warnings and instructions for future reference.

LINE TRIMMER SAFETY WARNINGS

Training

Read the instructions carefully. Be familiar with the controls and the correct use of the machine.

Never allow children, persons with reduced physical, sensory or mental capabilities or lack of experience and knowledge or people unfamiliar with these instructions to use the machine, local regulations may restrict the age of the operator.

Keep in mind, that the operator or user is responsible for accidents or hazards occurring to other people or their property.

Preparation

Before use, always visually inspect the machine for damaged, missing or misplaced guards or shields.

Never operate the machine while people, especially children, or pets are nearby.

Wear full eye and hearing protection while operating the product. If working in an area where there is a risk of falling objects, head protection must be worn.

Hearing protection may restrict the operator's ability to hear warning sounds, pay particular attention to potential hazards around and inside the working area.

Wear heavy long trousers, boots, and gloves. Do not wear loose fitting clothing, short trousers, jewellery of any kind, or use with bare feet.

Secure long hair so it is above shoulder level to prevent entanglement in moving parts.

Operation

Keep supply and extension cords away from cutting means.

Wear eye protection and stout shoes at all times while operating the machine.

Avoid using the machine in bad weather conditions especially when there is a risk of lightning.

Use the machine only in daylight or good artificial light.

Never operate the machine with damaged guards or shields or without guards or shields in place.

Switch on the motor only when the hands and feet are away from the cutting means.

Always remove the battery

- whenever the machine is left unattended
- before clearing a blockage
- before checking, cleaning or working on the machine
- after striking a foreign object
- whenever the machine starts vibrating abnormally

Take care against injury to feet and hands from the cutting means.

Always ensure that the ventilation openings are kept clear of debris.

Avoid using on wet grass.

Do not walk backwards when using the product.

Do not operate the product when there is a risk of lightning.

Do not expose the product to rain or wet conditions. Water entering an appliance will increase the risk of electric shock.

Keep bystanders, children and pets 15m away from the area of operation. Stop the product if anyone enters the area.

Keep the cutting attachment below waist level.

Keep hands and feet away from the cutting means at all times and especially when switching on the motor.

Beware, the cutting elements continue to rotate after the motor is switched off.

Beware of objects thrown by the cutting means. Clear debris like small stones, gravel and other foreign objects from the work area before starting operation. Wires or string may become entangled with the cutting means.

The small blade fitted to the lawn guard is designed to trim the new extended line to the correct length for safe and optimum performance. It is very sharp, do not touch it particularly when cleaning the product.

Make sure the cutting head attachment is properly installed and securely fastened.

Make sure all guards, deflectors, and handles are properly and securely attached.

Do not modify the product in any way, this may increase the risk of injury to yourself or others.

Use only the manufacturer's replacement cutting line. Do not use any other cutting attachment.

Do not use metallic cutting means

Immediately switch off and remove the battery pack in the event of accident or breakdown. Don't operate the product again until it has been fully checked by an authorised service centre.

Ensure that the cut-off blade is properly positioned and secured before each use.

Before use and after any impact, check that there are no damaged parts. A defective switch or any part that is damaged or worn should be properly repaired or replaced by an authorised service facility.

Never operate the product unless all guards, deflectors, and handles are properly and securely attached.

Consider the environment in which you are working. Keep the working area free from wires, sticks, stones, and debris which if struck by the cutter can become thrown objects.

Maintenance and storage

Remove the battery before carrying out maintenance or cleaning work.

Use only the manufacturer's recommended replacement parts and accessories (see page 15).

Inspect and maintain the machine regularly. Have the machine repaired only by an authorized repairer.

When not in use, store the machine out of the reach of children.

Never fit a metal replacement line.

Stop the product and allow it to cool before storing or transporting.

Clean all foreign material from the product. Store it in a cool dry and well-ventilated place that is inaccessible to children. Keep away from corrosive agents such as garden chemicals and de-icing salts. Do not store outdoors.

For storage, always remove the battery.

For transportation, secure the product against movement or falling to prevent injury to persons or damage to the product.

ADDITIONAL SAFETY INSTRUCTIONS

This appliance is not intended for use by persons (including children) with limited physical, sensory or mental capabilities or insufficient experience and/or knowledge unless they are supervised by a person who is responsible for their safety or have been instructed by them in the safe use of the tool.

Children should be supervised in order to ensure that they do not play with the tool.

Remove the battery pack before starting any work on the machine.

Do not dispose of used battery packs in the household refuse or by burning them.

Milwaukee Distributors offer to retrieve old batteries to protect our environment.

Do not store the battery pack together with metal objects (short circuit risk).

Use only System M18 chargers for charging System M18 battery packs. Do not use battery packs from other systems.

Battery acid may leak from damaged batteries under extreme load or extreme temperatures. In case of contact with battery acid wash it off immediately with soap and water. In case of eye contact rinse thoroughly for at least 10 minutes and immediately seek medical attention.

RESIDUAL RISK

Even when the product is used as prescribed, it is still impossible to completely eliminate certain residual risk factors. The following hazards may arise in use and the operator should pay special attention to avoid the following:

- Injury caused by vibration
Hold the product by designated handles and restrict working time and exposure.
- Exposure to noise can cause hearing injury
Wear ear protection and limit exposure.
- Injury due to flying debris
Wear eye protection, heavy long trousers, gloves and substantial footwear at all times.

SPECIFIED CONDITIONS OF USE

The product is only intended for use outdoors by a standing operator.

The product is designed for cutting grass, light weeds, and other similar vegetation at or about ground level.

The cutting plane should be approximately parallel to the ground surface when trimming.

The product should not be used to cut or trim hedges, bushes, or other vegetation where the cutting plane is not at or about ground surface level.

Do not use this product in any other way as stated for normal use.

NOTES FOR LI-ION BATTERIES

Use of Li-Ion batteries

Battery packs which have not been used for some time should be recharged before use.

Temperatures in excess of 50°C (122°F) reduce the performance of the battery pack. Avoid extended exposure to heat or sunshine (risk of overheating).

The contacts of chargers and battery packs must be kept clean.

For an optimum life-time, the battery packs have to be fully charged, after used.

To obtain the longest possible battery life remove the battery pack from the charger once it is fully charged.

For battery pack storage longer than 30 days:
Store the battery pack where the temperature is below 27°C and away from moisture
Store the battery packs in a 30% - 50% charged condition
Every six months of storage, charge the pack as normal.

Battery protection for Li-Ion Akkus

In extremely high torque, binding, stalling and short circuit situations that cause high current draw, the tool will vibrate for about 5 seconds, the fuel gauge will flash, and then the tool will turn OFF. To reset, release the trigger.

Under extreme circumstances, the internal temperature of the battery pack could raise too much. If this happens, the fuel gauge will flash until the battery pack cooled down. After the lights go off, the work may continue.

Transport of Lithium Batteries

Lithium-ion batteries are subject to the Dangerous Goods Legislation requirements.

Transportation of those batteries has to be done in accordance with local, national and international provisions and regulations.

- The user can transport the batteries by road without further requirements.
- Commercial transport of Lithium-Ion batteries by third parties is subject to Dangerous Goods regulations. Transport preparation and transport are exclusively to be carried out by appropriately trained persons and the process has to be accompanied by corresponding experts.

When transporting batteries:

- Ensure that battery contact terminals are protected and insulated to prevent short circuit.
- Ensure that battery pack is secured against movement within packaging.
- Do not transport batteries that are cracked or leak.

Check with forwarding company for further advice.

OPERATION

To feed out the line, bump the trimmer head spool against the ground gently while running a normal speed. NOTE: When used near abrasive surfaces or in dense growth, the cutting line will wear faster and require "bumping" more often.

CUTTING TIPS

Allow the ends of the line to do the cutting.

Contact between the line and solid objects will cause extra line wear and breakage.

Do not drag the spool cover along the ground or bump it too hard. Only bump spool on the ground. Do not bump against rocks, driveways, etc.

Make multiple passes in long growth.

Avoid ornamental trees, shrubs, and plantings. Avoid contact with siding, fence posts, etc. They can all be damaged by the trimmer.

REPLACING CUTTING LINE

Use only MILWAUKEE trimmer line (see technical data). Replace the cutting line with either 6 m of 2,4 mm line or 7,6 m of 2 mm line. Note, when used near abrasive surfaces or in dense growth, the cutting line will wear faster.

For replacing cutting line see picture section.

Under normal operation, the remaining string should be thrown from the spinning head during use. If any string remains in the head, or to remove a length of string to replace with a different type, turn the trimmer head over and press the release tabs and pull the cover away from the head.



Discard any short line remnants. Snap the cover back onto the trimmer head.

TRANSPORTATION AND STORAGE

Always turn off the tool when transporting from one location to another. Do not carry tool with finger on the trigger. Accidental starting can cause serious personal injury.

Remove the battery and allow it to cool before storing or transporting. Carry the tool by the front handle to avoid accidental starting. Proper handling of the tool will prevent injury.

For transportation in vehicles, secure the product against movement or falling to prevent injury to persons or damage to the product.

Clean all foreign materials from the product. Store the product in a cool, dry, and well-ventilated place that is inaccessible to children. Keep away from corrosive agents, such as garden chemicals and de-icing salts. Do not store outdoors.

Do not immerse in water or spray with a hose. Do not clean with a pressure washer. Water entering a power tool will increase the risk of electric shock. Store tool indoors.

Do not store the power tool on or near to fertilizers or chemicals.

MAINTENANCE

The ventilation slots of the machine must be kept clear at all times.

Servicing requires extreme care and knowledge and should be performed only by a qualified service technician. For service, we suggest you return the product to your nearest authorised service center for repair. When servicing, use only identical replacement parts.

Switch off and remove battery pack before conducting any maintenance or cleaning work.

You may make adjustments and repairs described here. For other repairs, contact the authorised service agent.

For replacement line, use only nylon filament line of the diameter described in the specification table of this manual.

After extending new cutter line, always return the product to its normal operating position before starting.

After each use, clean the product with a soft dry cloth. Any part that is damaged should be properly repaired or replaced by an authorised service centre.

Check all nuts, bolts, and screws at frequent intervals for proper tightness to ensure the product is in safe working condition.

Use only Milwaukee accessories and Milwaukee spare parts. Should components need to be replaced which have not been described, please contact one of our Milwaukee service agents (see our list of guarantee/service addresses).

If needed, an exploded view of the tool can be ordered. Please state the machine type printed as well as the six-digit No. on the label and order the drawing at your local service agents or directly at: Techtronic Industries GmbH, Max-Eyth-Straße 10, 71364 Winnenden, Germany.

SYMBOLS

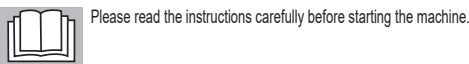

	CAUTION! WARNING! DANGER!
	Remove the battery pack before starting any work on the machine.
	Wear gloves!
	Wear ear protectors!
	Always wear goggles when using the machine.
	Wear safety shoes!
	Ensure that nobody is at risk of materials being catapulted out or falling.
	Keep distance.
	Never expose tool to rain.
	Beware of thrown or flying objects. Keep all bystanders a safe distance away from the product.
	Do not use metal blade(s) on the product.
	WARNING - Disconnect battery before maintenance.
	Parts or accessories sold separately.
	The guaranteed sound power level shown on this label is 96 dB.
	Do not dispose of waste batteries, waste electrical and electronic equipment as unsorted municipal waste. Waste batteries and waste electrical and electronic equipment must be collected separately. Waste batteries, waste accumulators and light sources have to be removed from equipment. Check with your local authority or retailer for recycling advice and collection point. According to local regulations retailers may have an obligation to take back waste batteries and Waste electrical and electronic equipment free of charge. Your contribution to re-use and recycling of waste batteries and waste electrical and electronic equipment helps to reduce the demand of raw materials. Waste batteries, in particular containing lithium and waste Electrical and electronic equipment contain valuable, recyclable materials, which can adversely impact the environment and the human health, if not disposed of in an environmentally compatible manner. Delete personal data from waste equipment, if any.

	No-load-speed
	Voltage
	Direct Current
	European Conformity Mark
	British Conformity Mark
	Ukraine Conformity Mark
	EurAsian Conformity Mark

GB-DECLARATION OF CONFORMITY

We declare as the manufacturer under our sole responsibility that the product described under "Technical Data" fulfills all the listed below relevant regulations and that the following designated standards have been used.

S.I. 2012/3032 (as amended)
S.I. 2016/1091 (as amended)
S.I. 2008/1597 (as amended)
S.I. 2001/1701 (as amended)
BS EN 60335-1:2012+A11:2014+A13:2017+A14:2019
+A1:2019+A2:2019+A15:2021
BS EN 50636-2-100:2014
BS EN IEC 55014-1:2021
BS EN IEC 55014-2:2021
BS EN 62233:2008
BS EN IEC 63000:2018
Measured sound power level: 93,6 dB (A)
Guaranteed sound power level: 96 dB (A)
Conformity assessment to Schedule 8 Directive S.I. 2001/1701
Notified Body No. 0158: DEKRA Testing and Certification GmbH,
Handwerkstraße 15, 70565 Stuttgart
Location Certification Body, Dinnendahlstr. 9, 44809 Bochum, Germany

Winnenden, 2022-02-21

Alexander Krug
Managing Director
Techtronic Industries GmbH
Max-Eyth-Straße 10
71364 Winnenden
Germany

Authorized to compile the technical file:
Techtronic Industries (UK) Ltd
Parkway
Marlow SL7 1YL
UK

Copyright 2022

Techtronic Industries GmbH
Max-Eyth-Str. 10
71364 Winnenden
Germany

+49 (0) 7195-12-0

www.milwaukeeetool.eu

Techtronic Industries (UK) Ltd
Parkway
Marlow SL7 1YL
UK

(10.22)

4100 4707 14